

LEGEND

● BOLLARD	MB MAILBOX	VP VENT PIPE
— BLDG SETBACK LINE	MON MONUMENT	WM WATER METER
● BTWP BT WARNING POST	OPP OVERHEAD POWER	WT WATER VALVE
C & G CURB & GUTTER	OHT OVERHEAD TELEPHONE	— BT BURIED TELEPHONE
CS CATON BASH	OTI OPEN THROAT INLET	— CT CABLE TELEVISION
CMP CORRUGATED METAL PIPE	PVC POLYVINYL CHLORIDE	— CN CENTERLINE
CO CLEAN OUT	PKNS P.K. NAIL & SHINER SET	— F FENCE
CONC CONCRETE	(STAMPED R. COLLINS L.S. 13408)	— FO FIBER OPTIC
▲ CP# CONTROL POINT NUMBER	POINT OF BEGINNING	— EC EROSION CONTROL
DWCI DOUBLE WING CURB INLET	PP POWER POLE	— GF GUY WIRE
E.O.C. EDGE OF CONCRETE	RD ROOF DRAIN	— GS GAS LINE
E.O.G. EDGE OF GRAVEL	REF. REFERENCE	— OP OVERHEAD POWER
E.O.P. EDGE OF PAVEMENT	RCP REINFORCED CONCRETE PIPE	— OHT OVERHEAD TELEPHONE
EX. EXISTING	SMH SANITARY SEWER MANHOLE	— SF SALT FENCE
F.F.E. FINISH FLOOR ELEVATION	SPHW SLOPED PAVED HEADWALL	— SS SANITARY SEWER
FLH FIRE HYDRANT	SPR SPRINKLER	— ST STORM SEWER
GFL GROUND FLOOD LIGHT	SS SANITARY SEWER	— T.O.B. TOP OF BANK
GM GAS METER	S-T.R. SECTION TOWNSHIP RANGE	— T.O.E. TOE OF BANK
GV GAS VALVE	STM STORM SEWER MANHOLE	— U UNDERGROUND ELECTRIC
GLWP GAS LINE WARNING POST	STR STRUCTURE	— W WATER LINE
GTTI GRATE TOP INLET	SWCI SINGLE WING CURB INLET	— 502 INTERMEDIATE CONTOUR
HIC HANDICAP	TP TELEPHONE PEDESTAL	— 500 INDEX CONTOUR
ICV IRRIGATION CONTROL VALVE	T.B.M. TEMPORARY BENCH MARK	— 502.25 EXISTING SPOT ELEV
INV. INVERT	TP TELEPHONE PEDESTAL	— 4.00 PROPOSED CONTOUR
IP.F. IRON PIN FOUND	T.S.P. TRAFFIC SIGNAL POLE	— 888.50 PROPOSED SPOT ELEV
IP.S. IRON PIN SET (CAPPED)	TYP. TYPICAL	
R. COLLINS L.S. 13408		
JB JUNCTION BOX		
LP LIGHT POLE		

Source of Information:
RLPY Book 2011, Page 26067

Note:
1. All fence line and overhead power line locations are approximate.
2. No easement information provided for overhead power lines.

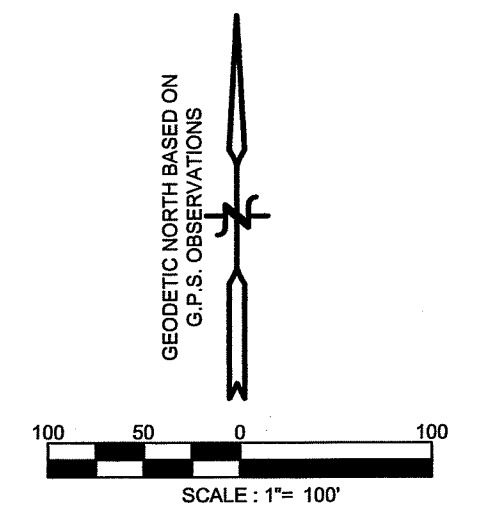

I HEREBY CERTIFY THAT ALL PARTS OF THIS SURVEY AND DRAWING HAVE BEEN COMPLETED IN ACCORDANCE WITH THE CURRENT REQUIREMENTS OF THE STANDARDS OF PRACTICE FOR SURVEYING IN THE STATE OF ALABAMA TO THE BEST OF MY KNOWLEDGE, INFORMATION, AND BELIEF.

Richard T. Collins L.S.
RICHARD T. COLLINS L.S.
ALABAMA LICENSE NO. 13406 DATE: 07/14/2017

DATE OF FIELD SURVEY: 07/14/2017

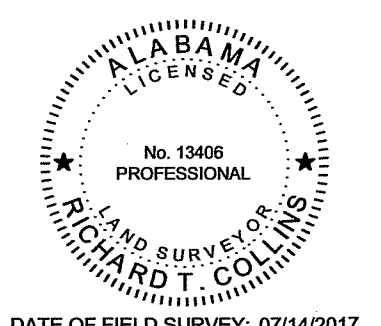

WLC civil engineers
land surveyors
White, Lynn, Collins, & Associates, Inc.
219 W. ALABAMA STREET • FLORENCE, ALABAMA 35630
PHONE (256) 766-1051 • FAX (256) 766-1201
EMAIL: WLCASSO@AOL.COM

57.52 Acres± (For Auction)
Part of Section 13 and
Section 14, Township 2 South, Range 12 West
Lauderdale County, Alabama

Boundary Survey
(Gary and Pam Devaney)
King Realty & Auction Company, Inc.
401 South Pine Street
Florence, Alabama 35630

HORZ 1"= 100'	SHEET
VERT 1"= 100'	OF
SURVEYED BY: [Signature]	CHECKED BY: [Signature]
DRAWN BY: [Signature]	DATE: [Date]
FILE: King-Devaney.dwg	LAYOUT: Layout (1)
CAD FILE: KING-DEVANEY-071217.dwg	TOTAL SHEETS
JOB NO.: 00340-17-06	OF
DATE: 07/14/2017	

ELECTRONIC FILE DISCLAIMER: The official drawings are those that are signed, sealed and dated by the Professional Engineer or Professional Land Surveyor. Information transferred electronically to clients is not necessarily a true representation of the official document. White, Lynn, Collins and Associates, Inc. is not responsible for information on these plans or surveys in electronic form, provided verbally by others, written by others or interpreted by others.

©Acad Drawings/ Acad Legal/King Realty - Devaney/King-Devaney.dwg/Layout (1), Aug/16/2017 - 8:34am, dawl